



New Vision for Georgia

October 23, 2012



U.S. Department
of Transportation
Federal Transit
Administration



Georgia Department of Transportation

P3 Process

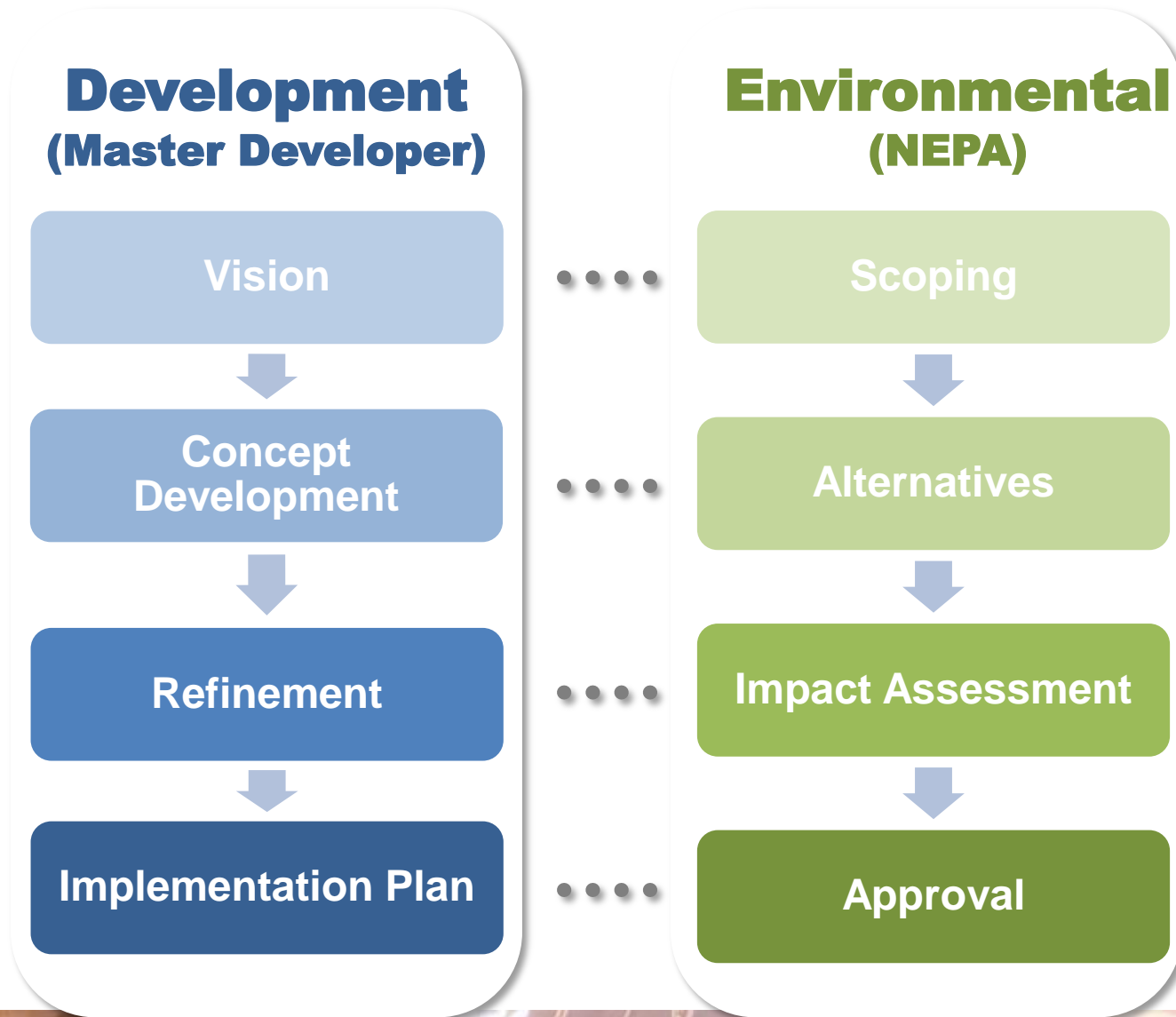

Stakeholder Involvement

- CSX
- Norfolk Southern
- City of Atlanta
- MARTA
- GRTA
- CAP
- GDOT
- ARC
- State of Georgia
- FTA
- FRA
- Cobb County Transit
- Gwinnett County Transit
- Atlanta BeltLine Inc.
- Amtrak
- Greyhound
- Southeastern Stages
- Megabus
- Zipcar
- PEDS
- Goldman Sachs
- Stifel Nicolaus
- GSA
- EPA
- Neighborhood Planning Units
- Atlanta Planning Advisory Board
- Castleberry Hill Neighborhood Association
- Georgia State University
- Atlanta University Center
- Georgia Tech University
- Georgia Perimeter College
- Atlanta Public Schools
- Atlanta Urban Design Commission
- The Georgia Trust for Historic Preservation
- Atlanta Preservation Center
- Metropolitan Public Art Coalition
- Georgia World Congress Center
- World of Coca-Cola
- Georgia Aquarium
- Philips Arena
- CNN
- Fulton County Recreational Authority
- Atlanta Convention & Visitors Bureau
- Homeland Security
- Atlanta Journal & Constitution
- Atlanta Business Chronicle
- Telemundo
- Atlanta Community Food Bank
- And more...

**Collaboration with Stakeholders on the
Local, State, & National Levels**



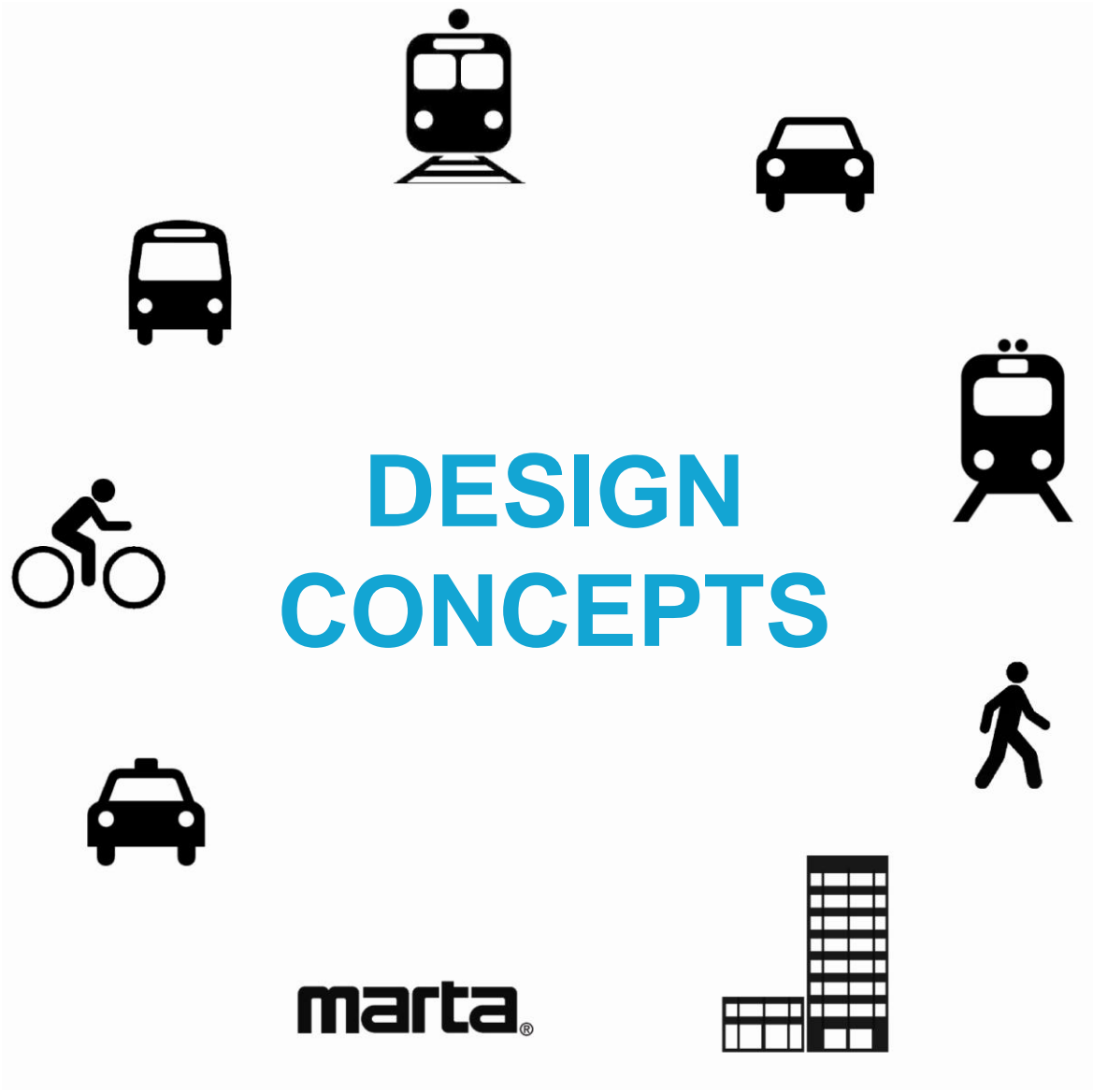

5 Qualities of a Great Transportation Center

1. Civic Presence
2. Clarity / Legibility / Orientation
3. Great Main Hall
4. Vibrant & Convenient
5. Forward Thinking

Design Concepts



Design Concepts



Transbay Terminal – San Francisco, CA



Liege Station – Liege, Belgium

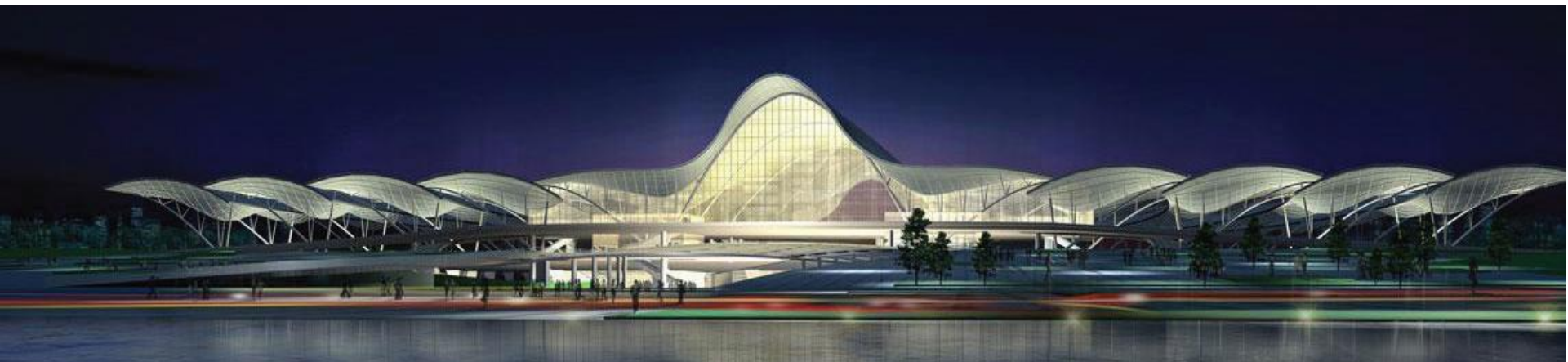

Wuhan Railway Station – Wuhan, China

The Site

Existing Conditions



Why these sites?

Study Area

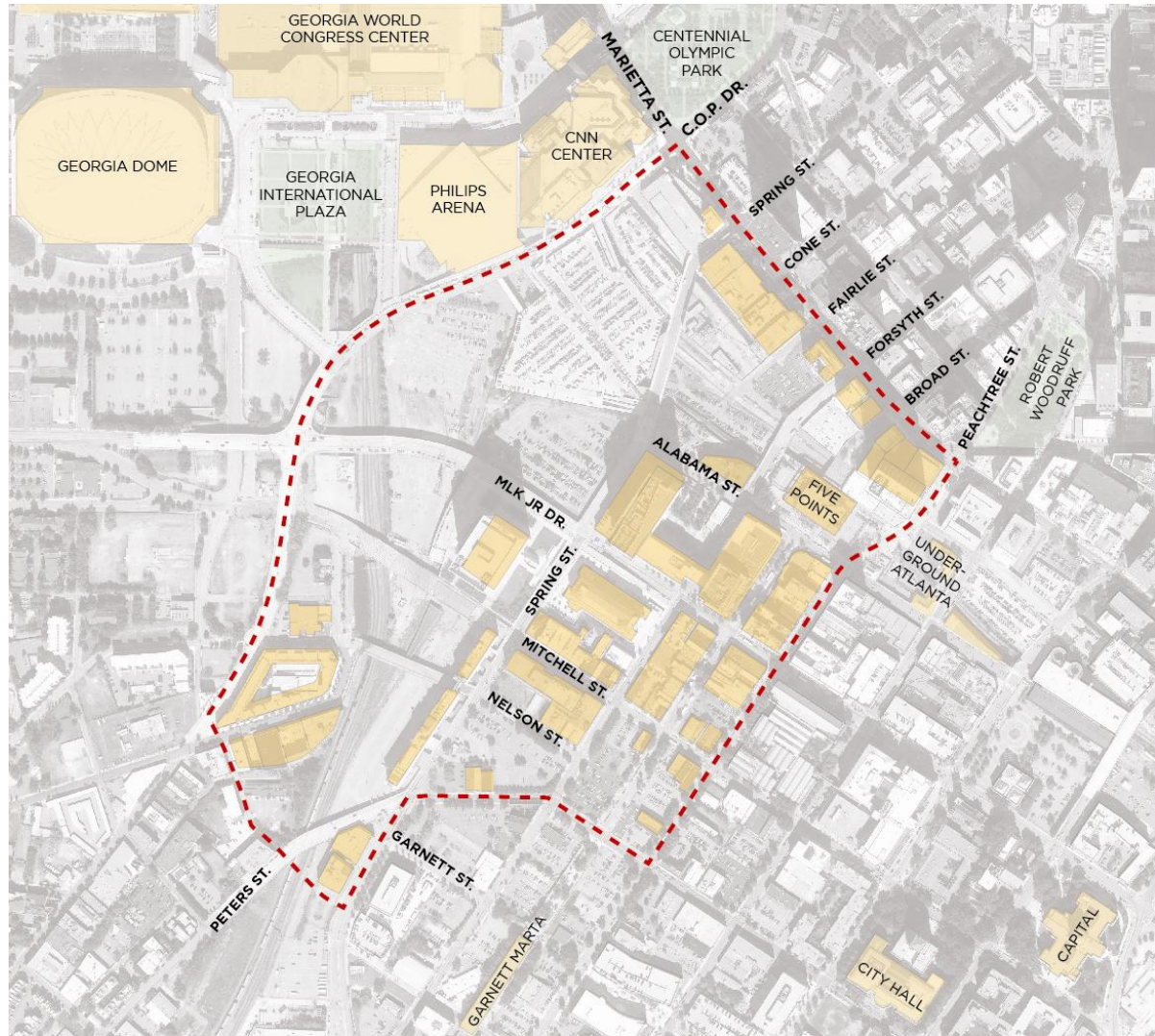

Why these sites?

Locate above
train platforms

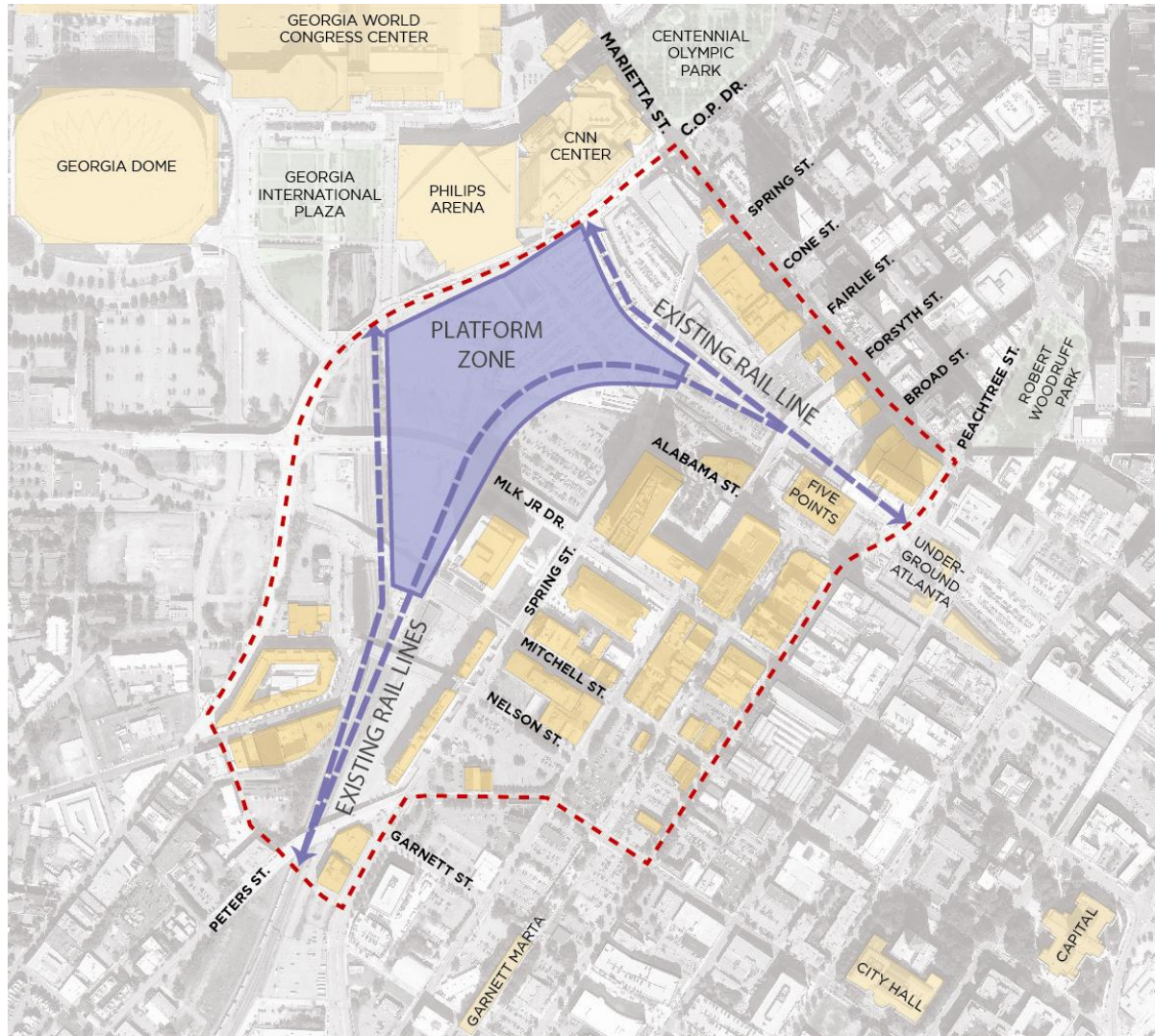

Why these sites?

Integrate with
existing and
proposed street
grid

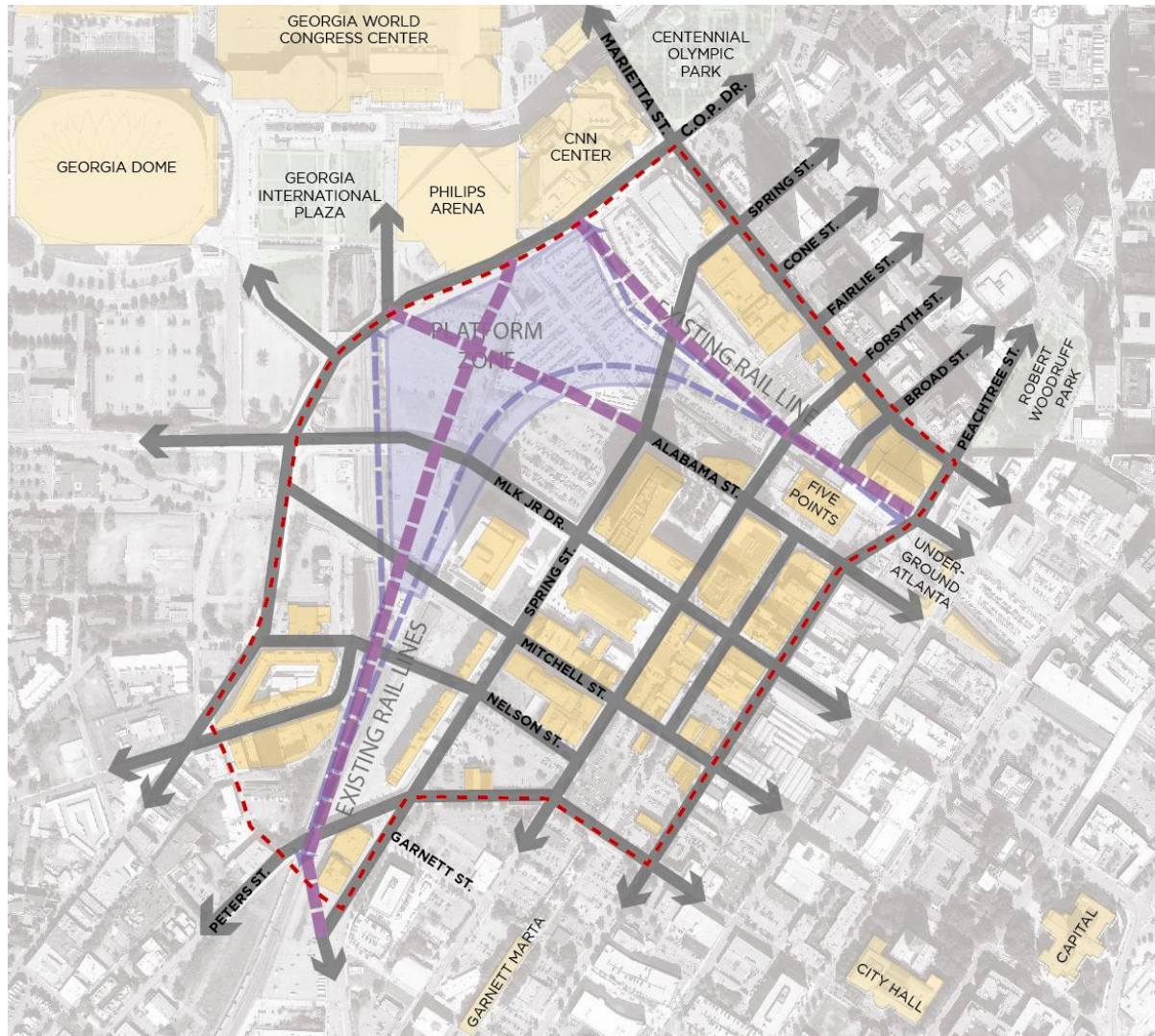

Why these sites?

Connect to Five
Points MARTA
Station

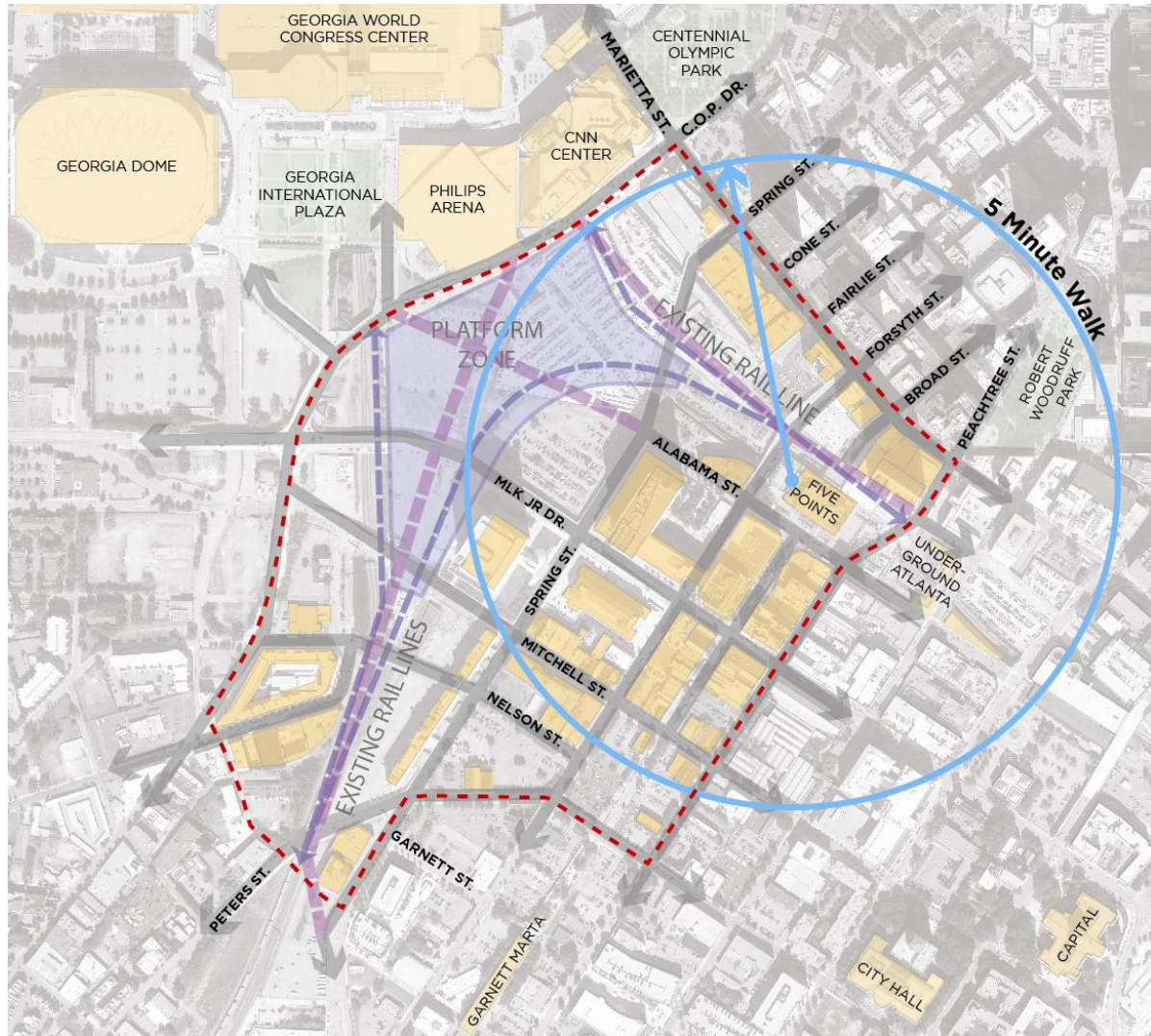

Why these sites?

Bus program
requires large
area

MMPT PROGRAM FOOTPRINT

(ABOVE TRACK LEVEL, TO SCALE)

ON 4 LEVELS

ON 3 LEVELS

ON 2 LEVELS

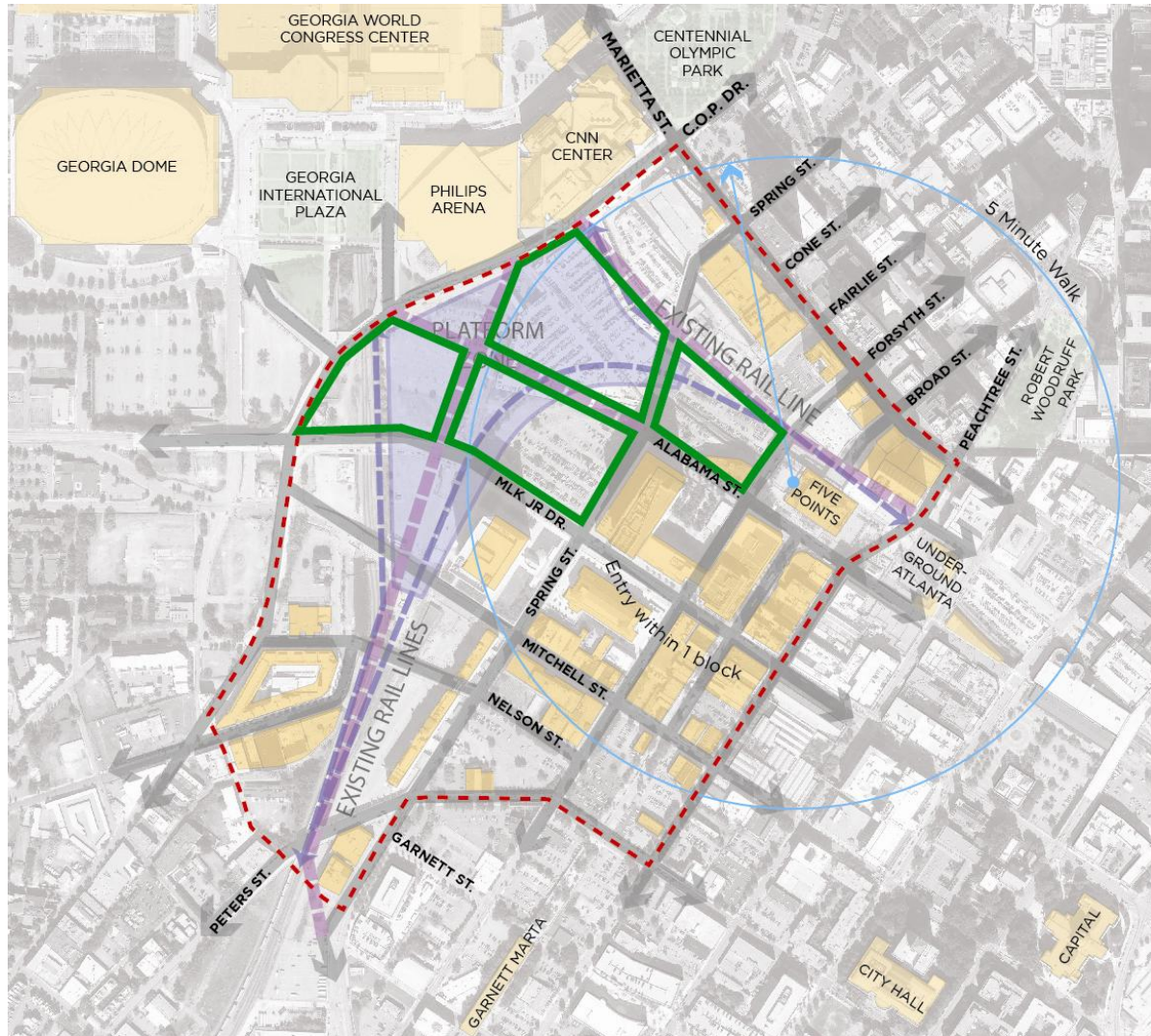

Why these sites?

Resulting sites

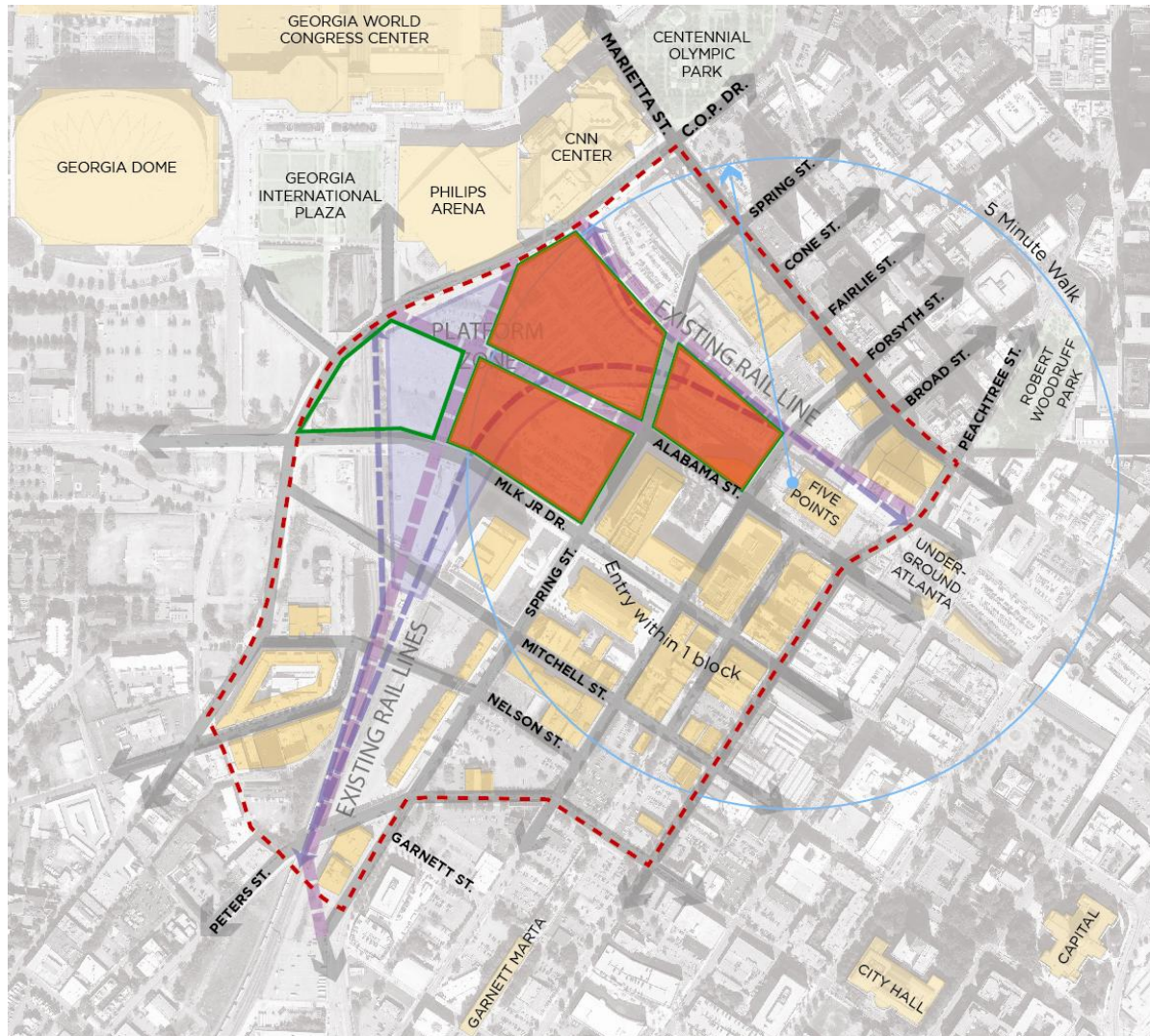

Design Scenarios

Walking Distance Comparisons



SITE PLAN

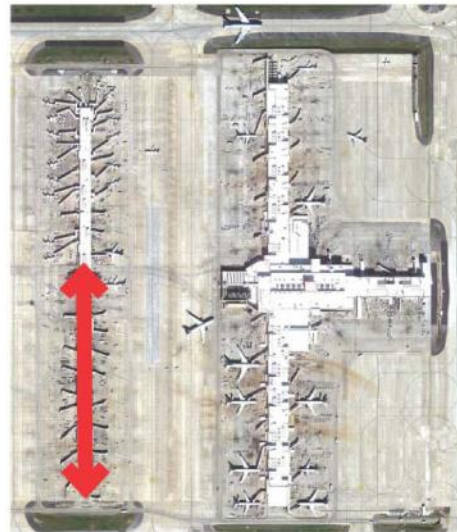

TERMINAL 'A' AND 'F' - HARTSFIELD-JACKSON
ATLANTA INTERNATIONAL AIRPORT



PERIMETER MALL

WALKING DISTANCES COMPARISONS (AVERAGE 5 MINUTE WALK)

MMPT Program

Common Features



80 BUS BAYS



5 RAIL PLATFORMS



STREET CAR PLATFORMS



CAR PARKING



TAXI/SHUTTLE DROP OFF



PEDESTRIAN & BICYCLE AMENITIES



CONNECTION TO MARTA 5 POINTS



POTENTIAL FOR PRIVATE DEVELOPMENT

Design Concept A

Site Plan

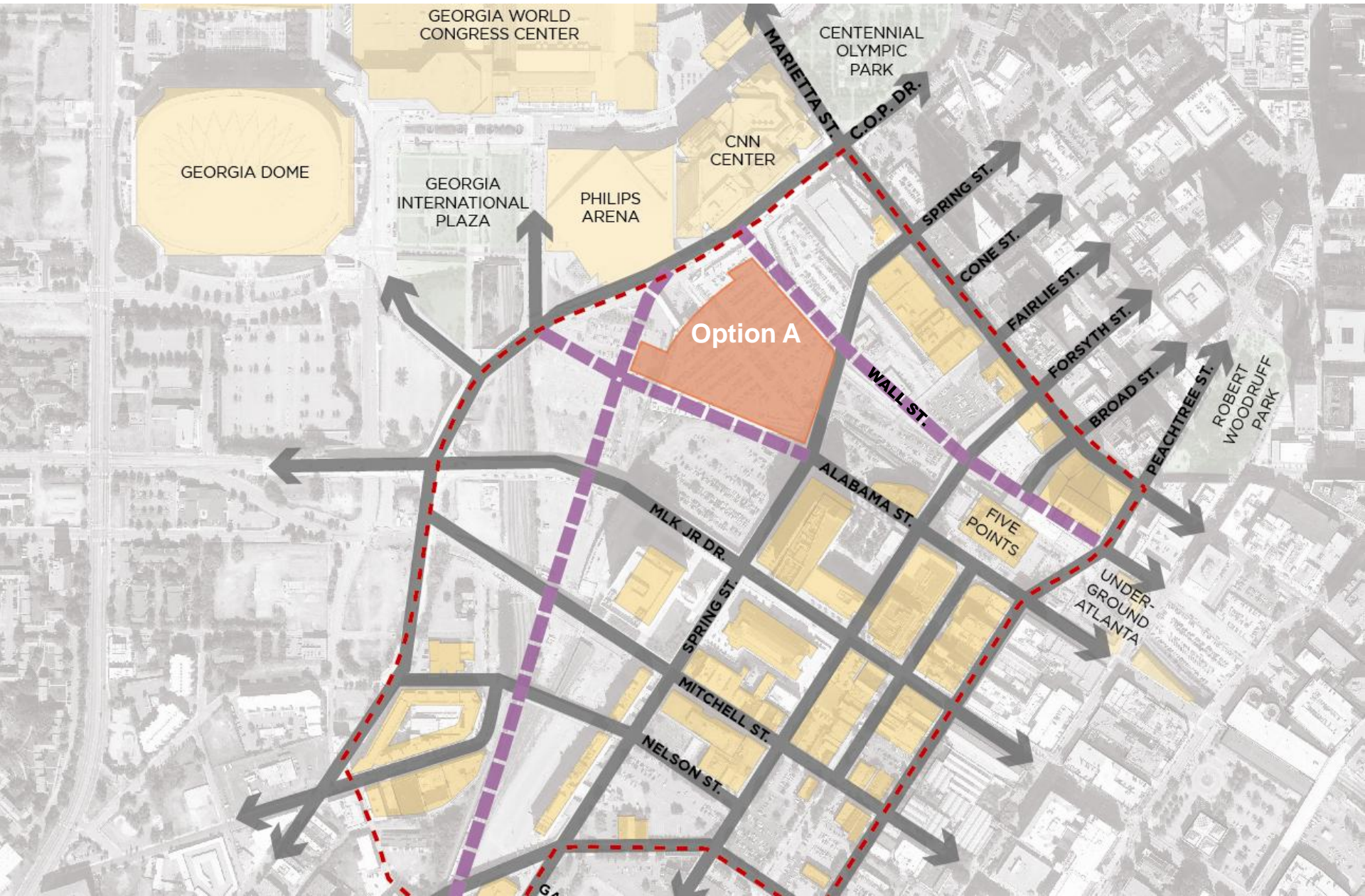

Design Concept A



Design Concept A

Concept Diagram

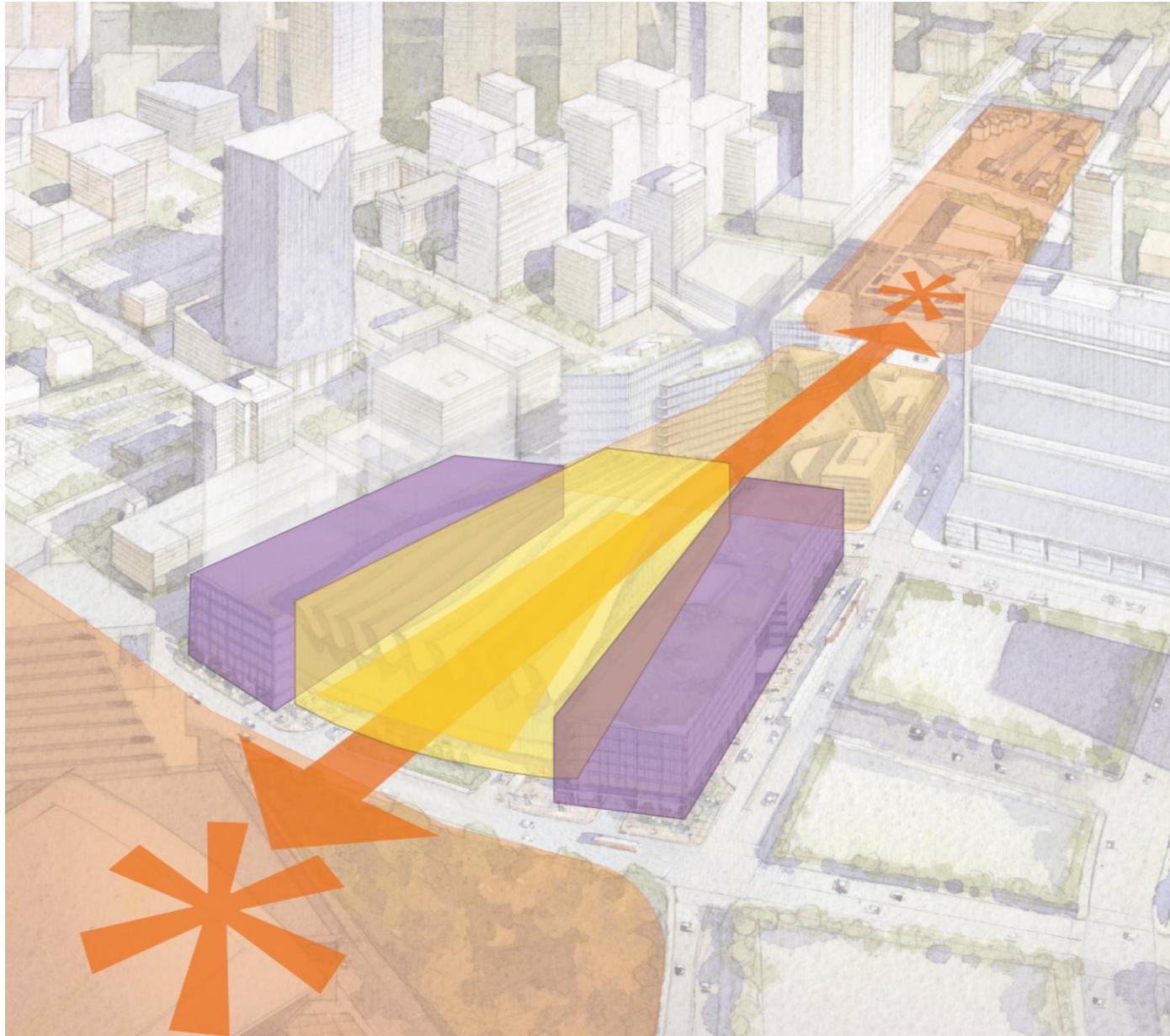

Design Concept B

Site Plan

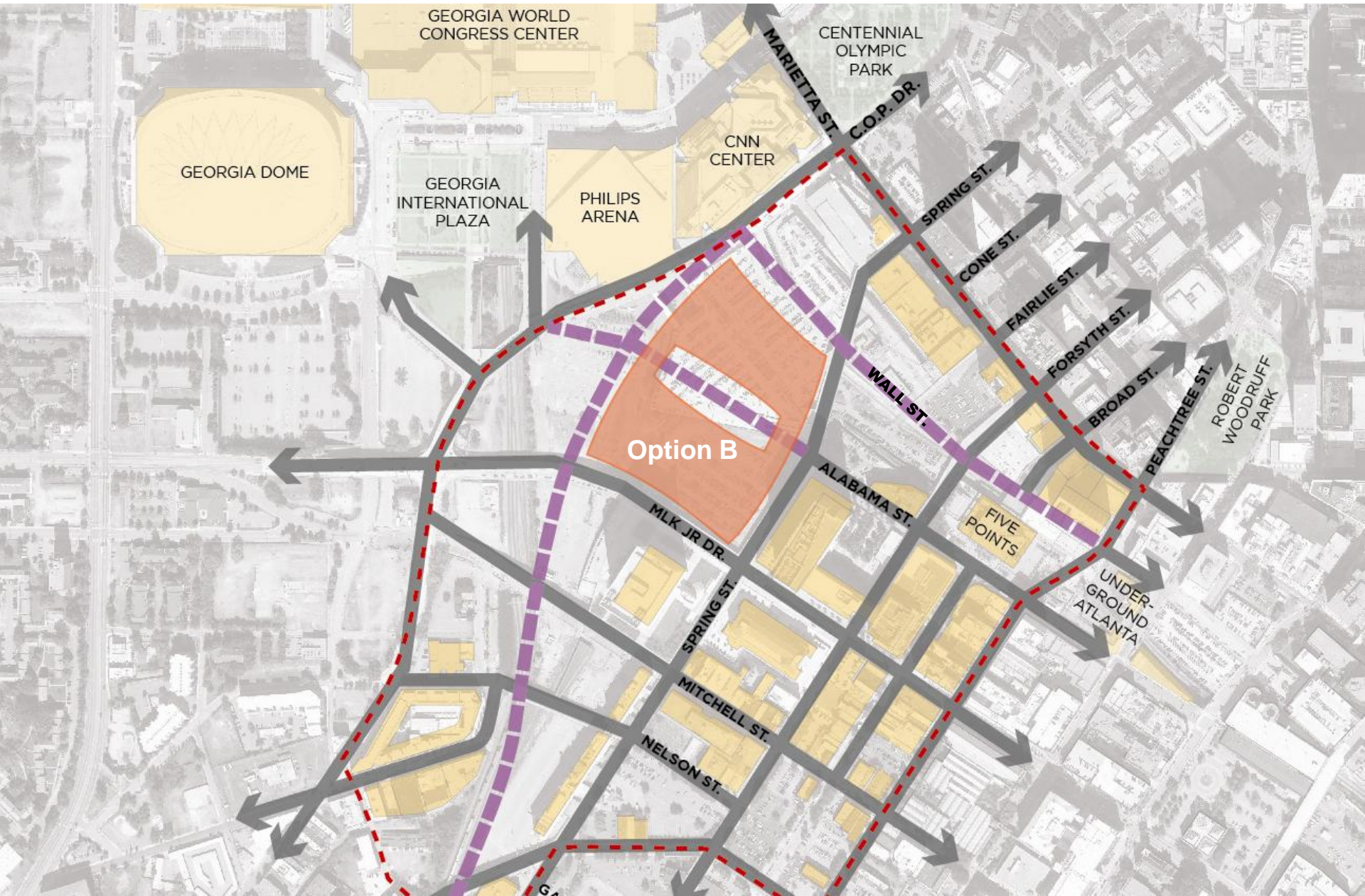

Design Concept B



Design Concept B

Concept Diagram

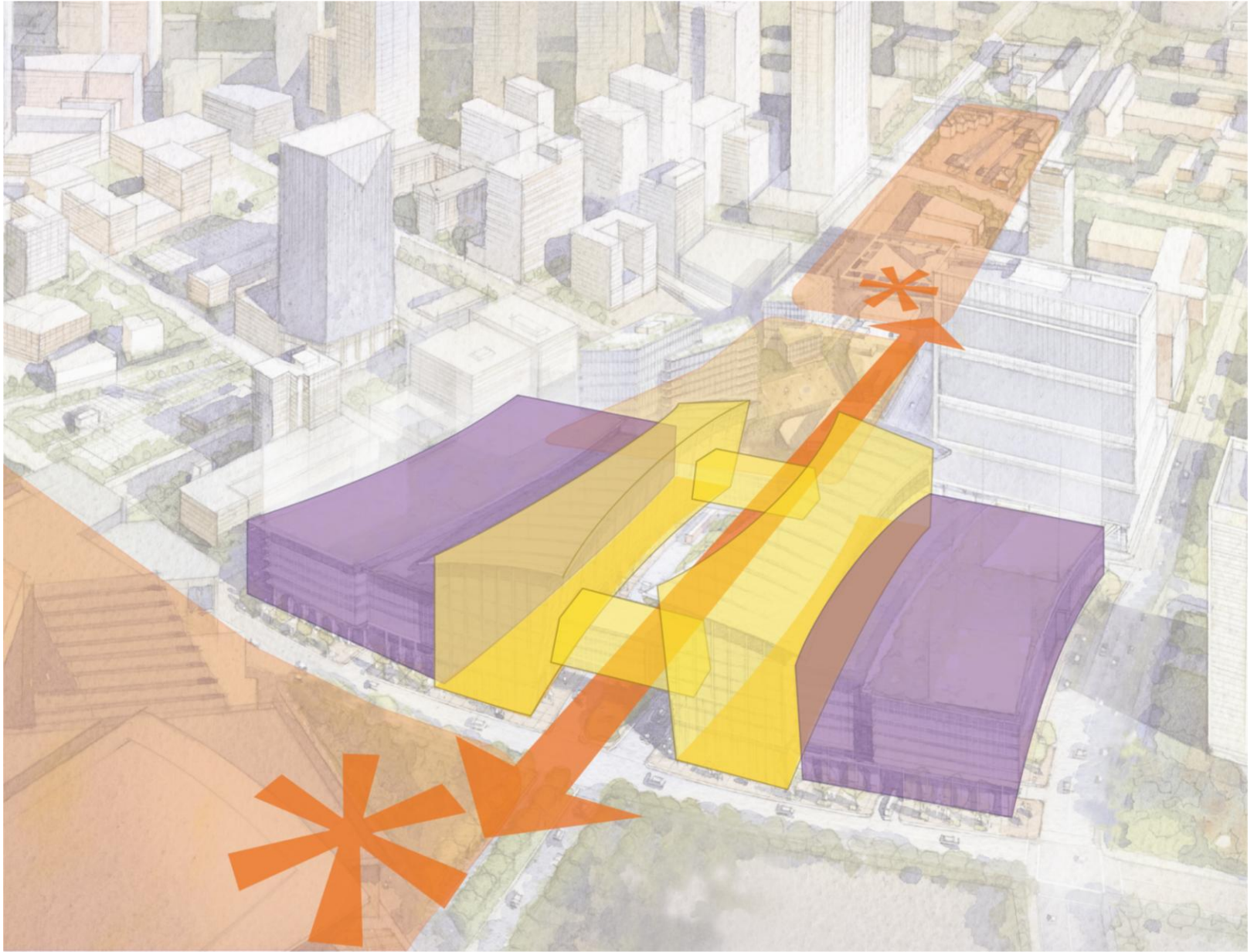

Design Concept C

Site Plan

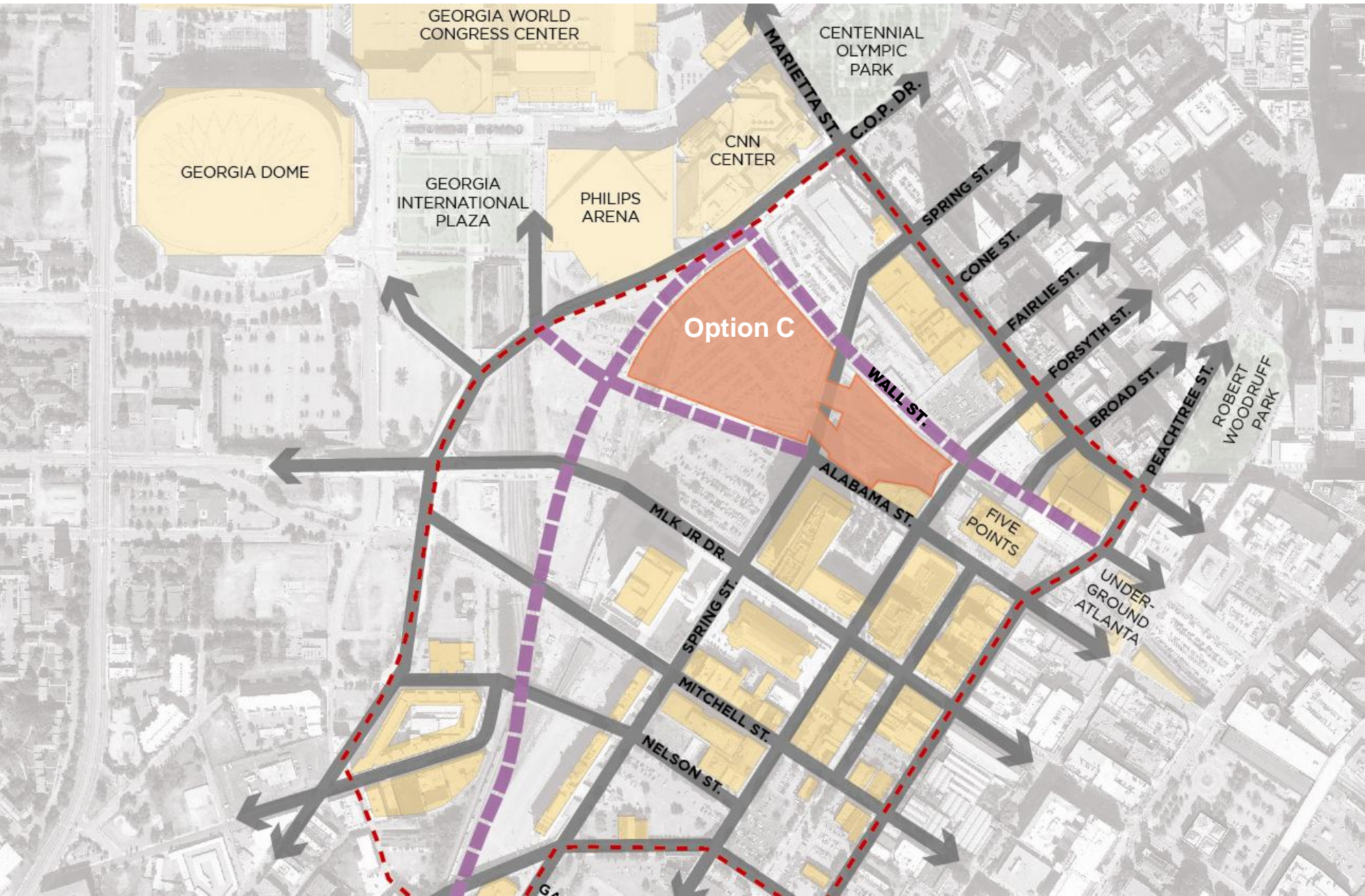

Design Concept C



Design Concept C

Concept Diagram

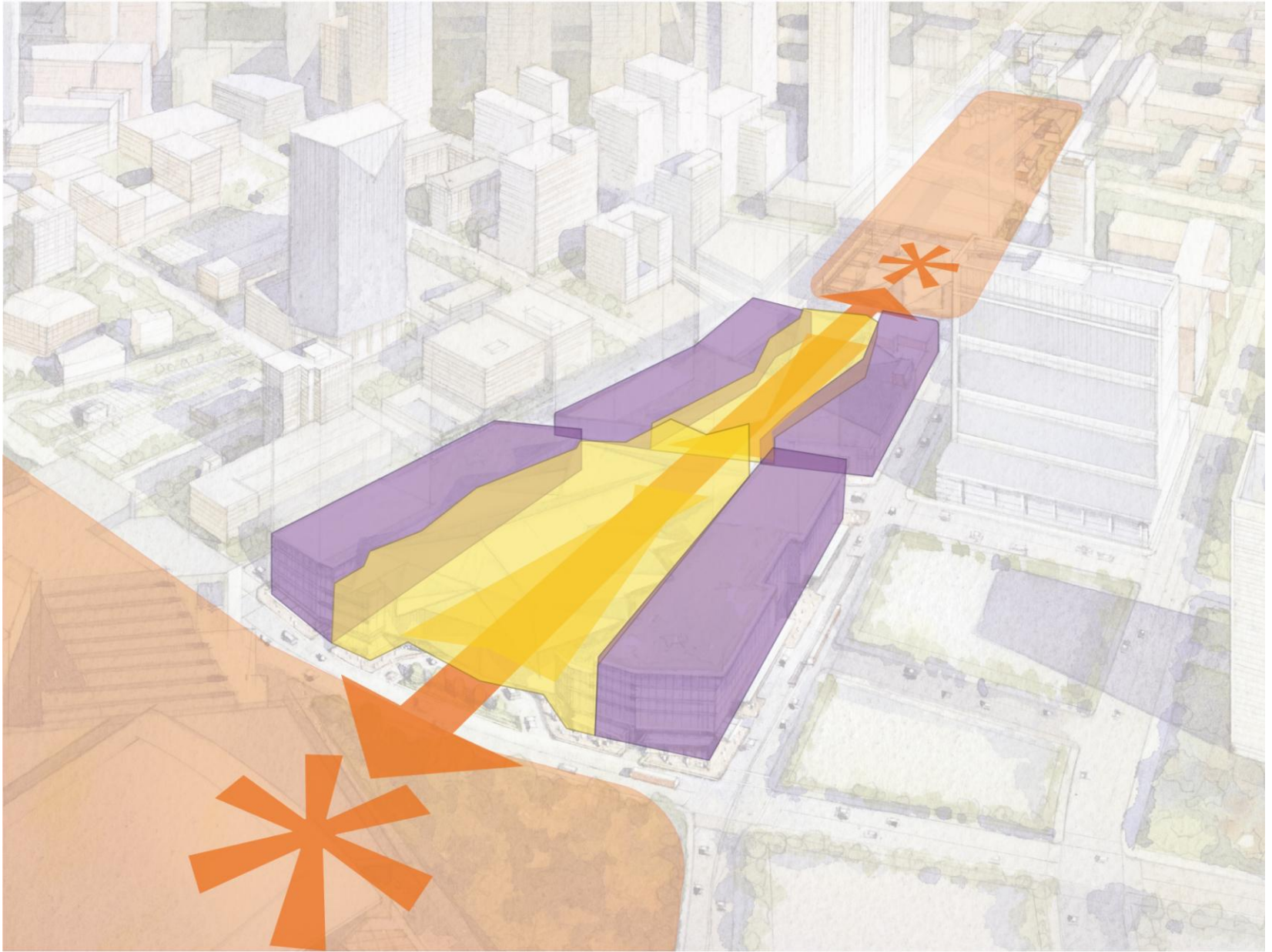

Design Concepts

Number of Blocks and Number of Bus Levels

Option A

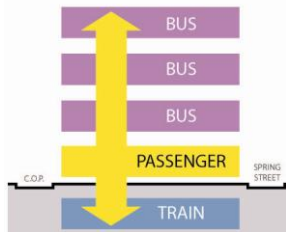

1 Block
3 Bus Levels

Option B

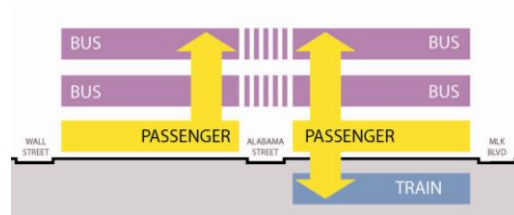

2 Blocks
2 Bus Levels

Option C

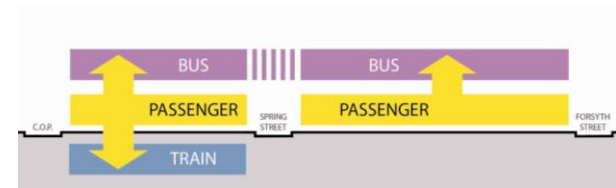

2 Blocks
1 Bus Level

Presidential *We Can't Wait* Initiative

Expedited to a nationally and regionally significant infrastructure project, shaving up to a year off the review timeline for the project



“This project is an example of a true partnership, a team, a commitment to moving Metro Atlanta forward.”

Congressman John Lewis